

SIAMP

Monaco

GB

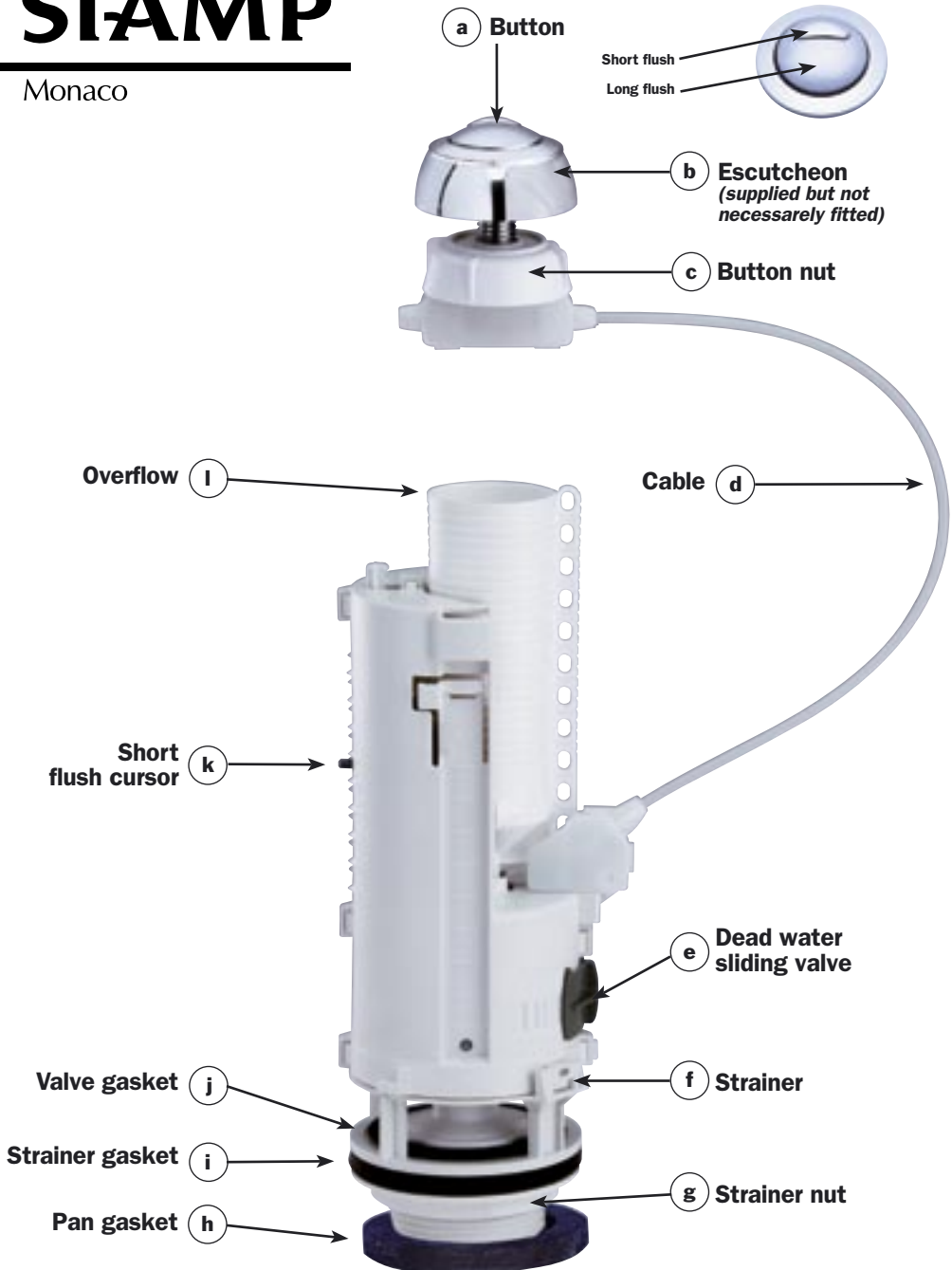

OPTIMA 50

I - PREPARING THE MECHANISM

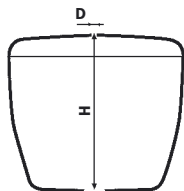

Measure the cistern

-H (from the top of the lid to the inside base of the cistern)

-D (diameter of the hole in the lid)

- 1 In the table below, choose the right level for the overflow shortening
- 2 Unscrew the strainer nut (g)

Height H of cistern		Overflow tube shortening
Diameter D of hole in lid 18 to 38 mm and 45 to 50 mm	Diameter D of hole in lid 38 to 44 mm	Cut between
> 332 mm	> 350 mm	No cut
327 to 332	345 to 350	A and B
322 to 326	340 to 344	B and C
317 to 321	335 to 339	C and D
312 to 316	330 to 334	D and E
307 to 311	325 to 329	E and F
302 to 306	320 to 324	F and G
297 to 301	315 to 319	G and H
292 to 296	310 to 314	H and I
287 to 291	305 to 309	I and J
282 to 286	300 to 304	J and K
277 to 281	295 to 299	K and L
272 to 276	290 to 294	L and M

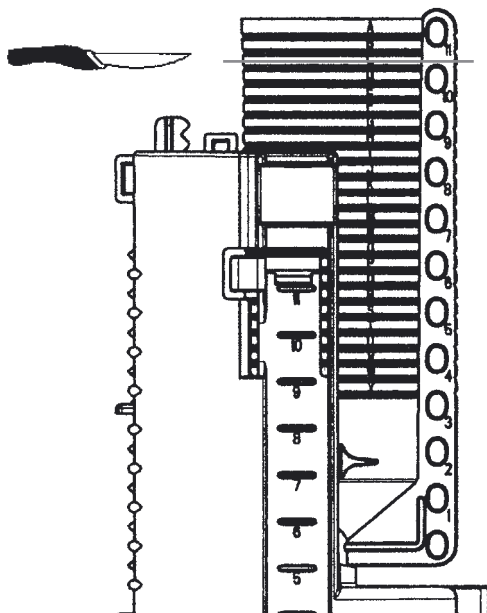

II - INSTALLATION

Position the mechanism in the cistern and secure it in place with the nut (g)

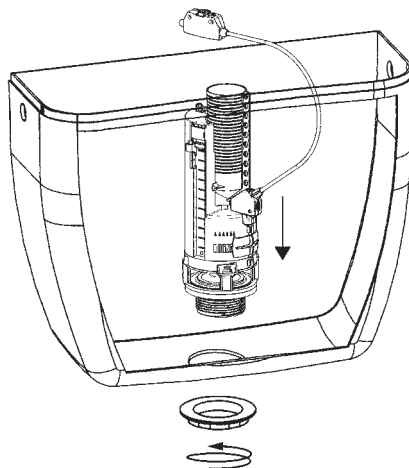

III - ASSEMBLING BOWL AND CISTERN

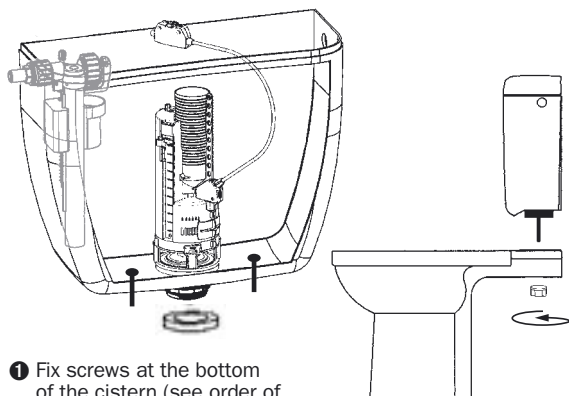

- 1 Fix screws at the bottom of the cistern (see order of parts below)
- 2 Position the latex foam gasket on the nut (g)
- 3 Position the cistern on the bowl and secure it with wing nuts

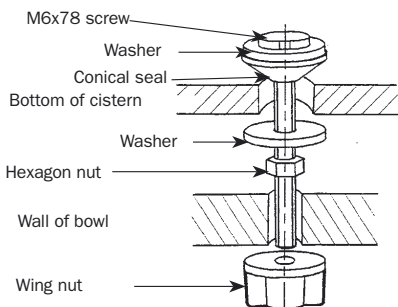

V - INSTALLATION OF BUTTON

- 1 Once the set-up has been completed, place button (a) on lid and screw button nut (c), (if the hole in the lid (D) is > 38 mm and < 45 mm, remove the escutcheon (b))

- 2 Clip cable case

- 3 Place lid back on top of cistern

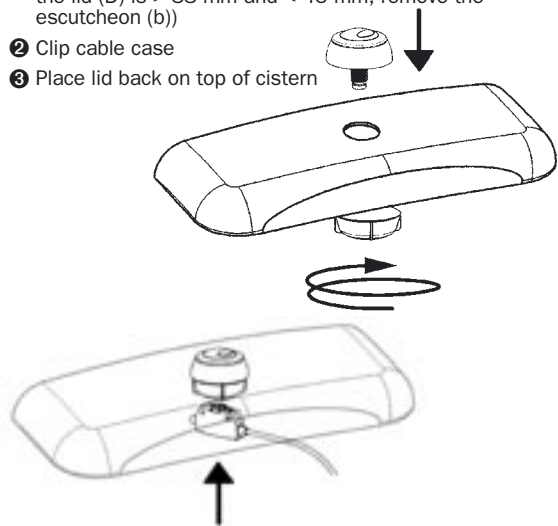

IV - SETTING WATER LEVEL

After having connected your ballcock to the water supply, open the tap and set the level of the long flush using the ballcock (see overleaf).

Note: The max. water level should be 20 mm lower than the overflow tube (l).

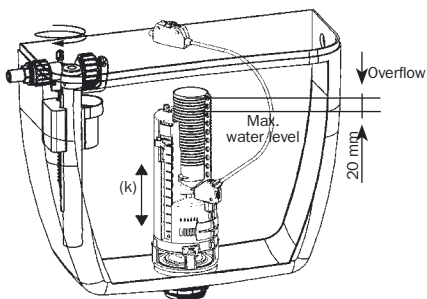

To adjust the water level of the short flush, slide the cursor along (k).

Note : The closer the cursor is to 18, the more water will be flushed.

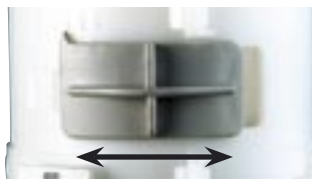

In some (rare) cases, the dead water level (amount of water remaining after the long flush) must be increased to ensure more efficient cleaning. To do this, move the sliding valve (e) to the left (the more it is open, the more the residual water increases).

Note: Increasing the dead water reduces the volume of water flushed. If necessary, readjust the max. water level using the ballcock.

VI - MAINTENANCE

Changing the valve gasket

- 1 After having opened the cistern, turn the mechanism 90° to separate it from its strainer
- 2 Change the valve gasket
- 3 Reposition the mechanism, locking it into the strainer
- 4 Close the cistern again.

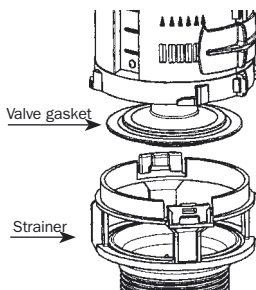

INSTALLING THE FLOAT VALVE

ROBECO 06 and STANDARD 15EL

- 1 Position valve
- 2 Fasten with nut
- 3 Connect to water supply
- 4 Adjust water level with the adjustment screw (15 EL) or by bending the rod (06)

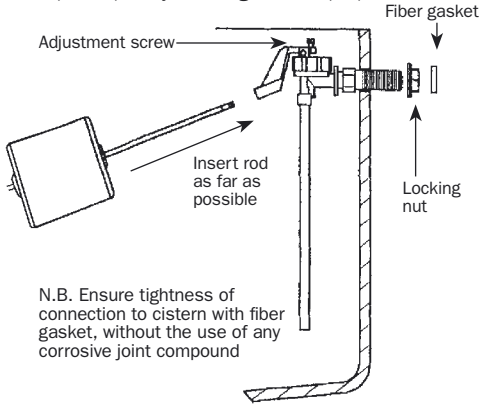

COMPACT 95L

- 1 Position valve
- 2 Fasten with nut
- 3 Connect to water supply
- 4 Adjust water level with the adjustment screw

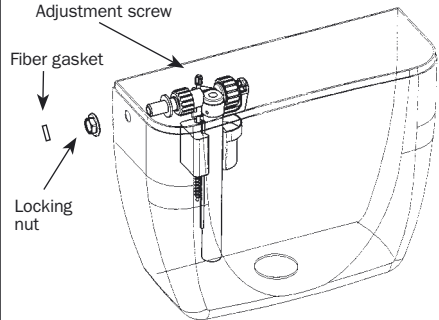

COMPACT 99B and HANDY 93B

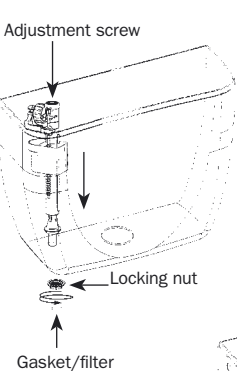

N.B. Ensure tightness of connection to cistern with filter gasket.

WARNINGS:

- 1 - Do not overtight in any case.
- 2 - Do not use any sealing paste and/or compound in any case
- 3 - Do not use connector handling the internal part of the inlet valve.

SIAMP will be not responsible in case these warnings are not respected.

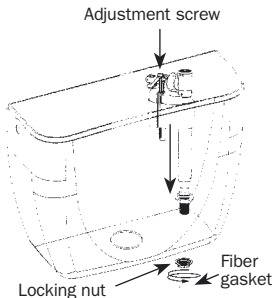

MAINTENANCE (95L & 99B)

